

System

Commissioning Guide

Version: 01

Release date: 2024-01-25



Copyright Notice

Copyright© 2023 Sigenergy Technology Co., Ltd. All Rights Reserved.

Description in this document may contain predictive statements regarding financial and operating results, product portfolio, new technology, configurations and features of product. Several factors could cause difference between actual results and those expressed or implied in the predictive statements. Therefore, description in this document is provided for reference purpose only and constitutes neither an offer nor an acceptance. Sigenergy Technology Co., Ltd. may change the information at any time without notice.



SIGENERGY

and other Sigenergy trademarks are owned by Sigenergy Technology Co., Ltd.

All trademarks and registered trademarks in this document belong to their owners.



Website



LinkedIn



YouTube

www.sigenergy.com

Contents

| | |
|---|------------|
| Revision History | 5 |
| Overview | 6 |
| Chapter 1 Commissioning for System Creation | 7 |
| 1.1 App Download | 7 |
| 1.2 Installer Account Registration | 8 |
| 1.3 System Creation for Device | 10 |
| Chapter 2 Daily O&M of Power Station & Equipment | 12 |
| 2.1 Connotation of Signs | 13 |
| 2.2 View the Operation Information | 14 |
| 2.2.1 Power station information | 15 |
| 2.2.2 Device information | 16 |
| 2.3 Query Alarm Information | 17 |
| 2.3.1 All power station alarms | 17 |
| 2.3.2 Single power station alarm | 18 |
| 2.4 Power Station Parameter Setup | 19 |
| 2.4.1 Change the station name | 19 |
| 2.4.2 Anti-countercurrent parameters setup | 错误! 未定义书签。 |
| 2.4.3 Set the energy storage operating mode | 20 |
| 2.4.4 Charge & discharge settings | 23 |
| 2.4.5 Reserve capacity setup | 24 |
| 2.4.6 Power Station Detection | 25 |
| 2.5 Device Parameters Setup | 26 |
| 2.5.1 Log download | 26 |
| 2.5.2 Inverter parameters setup | 27 |
| 2.5.3 SigenStor settings | 29 |
| 2.5.4 Equipment Powering-on/Power-off | 33 |
| Chapter 3 Others | 34 |
| 3.1.1 Change password | 34 |
| 3.1.2 Change language | 34 |
| 3.1.3 Change nickname | 34 |

| | |
|--|-----------|
| 3.1.4 Change the Interface Style | |
| 3.1.5 Upgrade the mySigen software | 34 |
| 3.1.6 View warranty information | 34 |
| Chapter 4 Exit the Account | 35 |
| Chapter 5 FAQs | 36 |
| 5.1 What if the user does not receive the account activation email? | 36 |
| 5.2 What should I do if the activation of the account times out? | 36 |
| 5.3 What should I do if I encounter problems during operations like initiation? | 37 |
| 5.4 How can I proceed if I haven't received the email (verification code, log, etc.) sent by the system? | 37 |

Revision History

| Version | Date | Description |
|---------|------------|-------------------------|
| 01 | 2023.08.31 | First official release. |

Overview

Introduction

This document principally covers how to use the mySigen App and the WEB version or MAC and Windows versions of Sigen Cloud.



Readers

This document is intended for:

- Trained and qualified installation personnel
- Technical support engineer

Sign Definition

The following signs may be used in the document to indicate security precautions or key information. Before installation and operation, familiarize yourself with signs and their definitions.

| Signs | Definition |
|--|---|
|  Danger | Danger. Failure to comply may result in death or serious personal injury. |
|  Warning | Danger. Failure to comply may result in serious personal injury or property damage. |
|  Caution | Caution. Failure to comply will result in property damage. |
| Tips | Important or key information, and supplementary operation tips. |

Chapter 1 Commissioning for System Creation

Tips

- Please use the App version of mySigen to create new system for the device. This document takes version 1.3.0 as an example to describe related operations.
- Please make sure that the device is powered on before starting operation.

1.1 App Download

Tips

Mobile OS requirements: Android 6.0, iOS 12.0 or later versions.

Download the App in the following two ways.

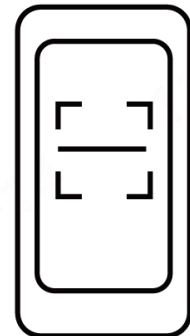

SSA1CM00014

1.2 Installer Account Registration

Method 1: Web operation

Please enter the “Partner” → “Register Now” at the Company's official website (<https://www.sigenergy.com>), and complete the account registration based on facts.

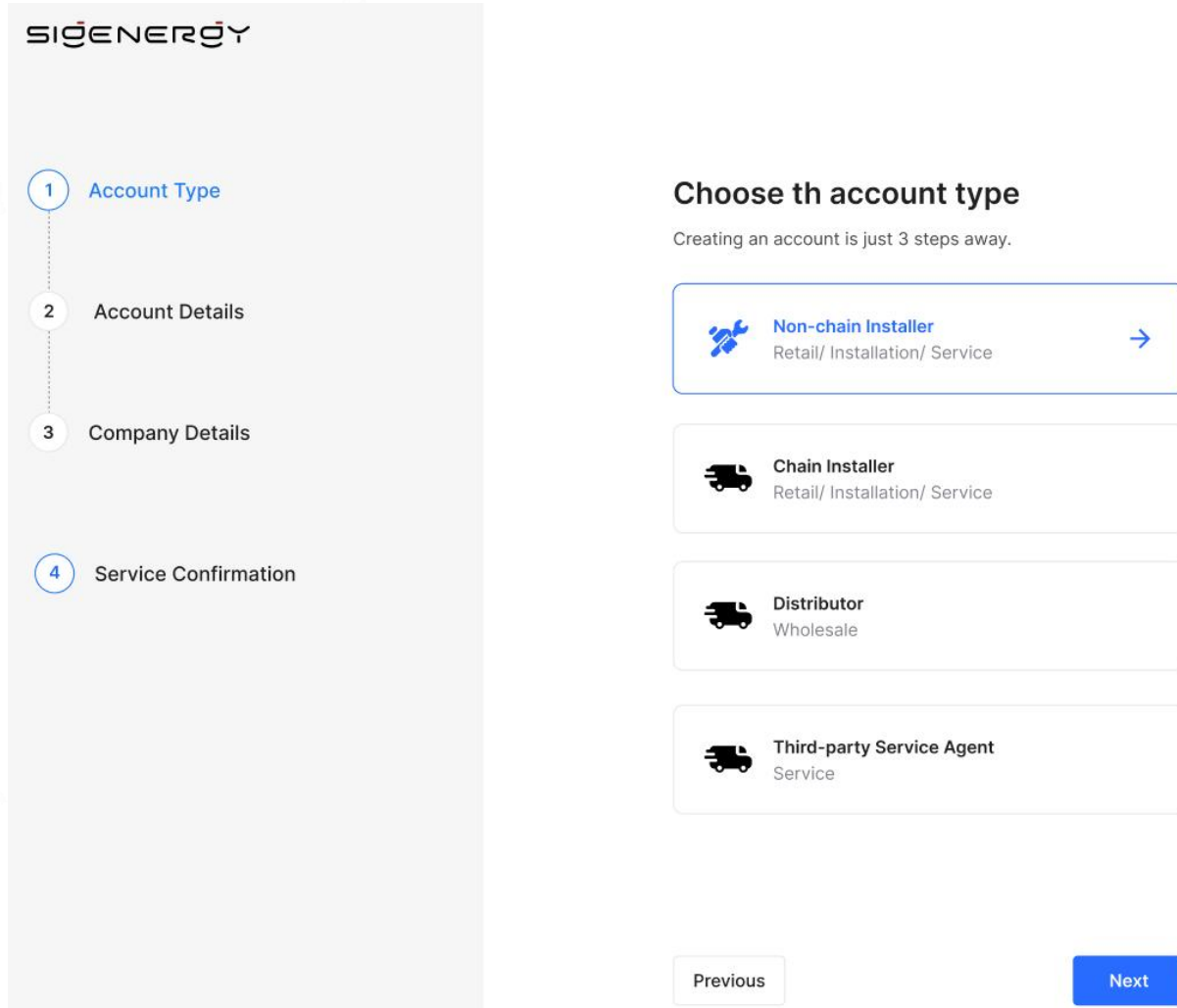

The screenshot displays the SIGENERGY registration process. On the left, a vertical progress bar indicates four steps: 1. Account Type (highlighted in blue), 2. Account Details, 3. Company Details, and 4. Service Confirmation. The main content area is titled "Choose th account type" (note the typo 'th' for 'the') and includes the text "Creating an account is just 3 steps away." Below this, four account type options are listed, each with an icon and a description:

- Non-chain Installer** (Retail/ Installation/ Service): Represented by a wrench and screwdriver icon. This option is highlighted with a blue border and a blue arrow on the right.
- Chain Installer** (Retail/ Installation/ Service): Represented by a truck icon.
- Distributor** (Wholesale): Represented by a truck icon.
- Third-party Service Agent** (Service): Represented by a truck icon.

At the bottom of the selection area, there are two buttons: "Previous" (disabled) and "Next" (active).

Method 2: App operation

Register an account under the App's “Sign Up” interface based on facts.

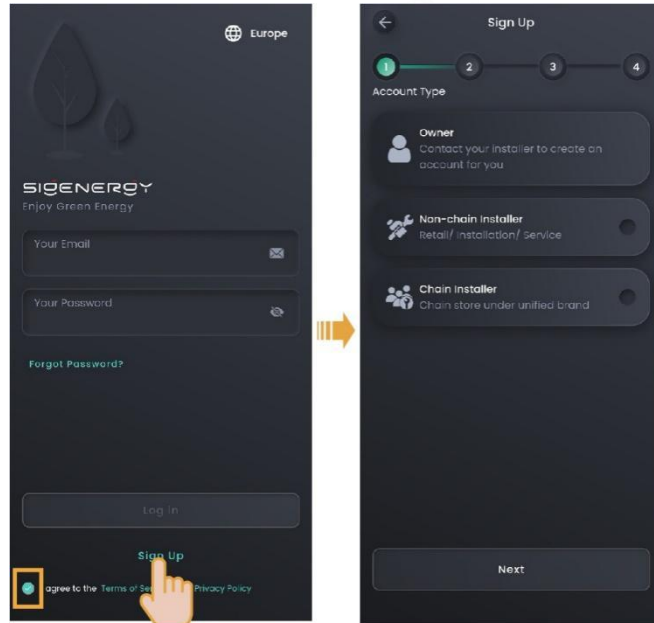

MSA1CM00001

1.3 System Creation for Device

Tips

Do not use only WLAN communication for creating the new system. To use the WLAN, install Sigen CommMod or RJ45 network cables at the same time. Otherwise, it would be impossible to create the new system.

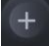
1. Click  in the upper right corner of "Home" page to enter the interface of the new power station. Complete the station building operation, and the App will push the account number to the user's e-mail box.

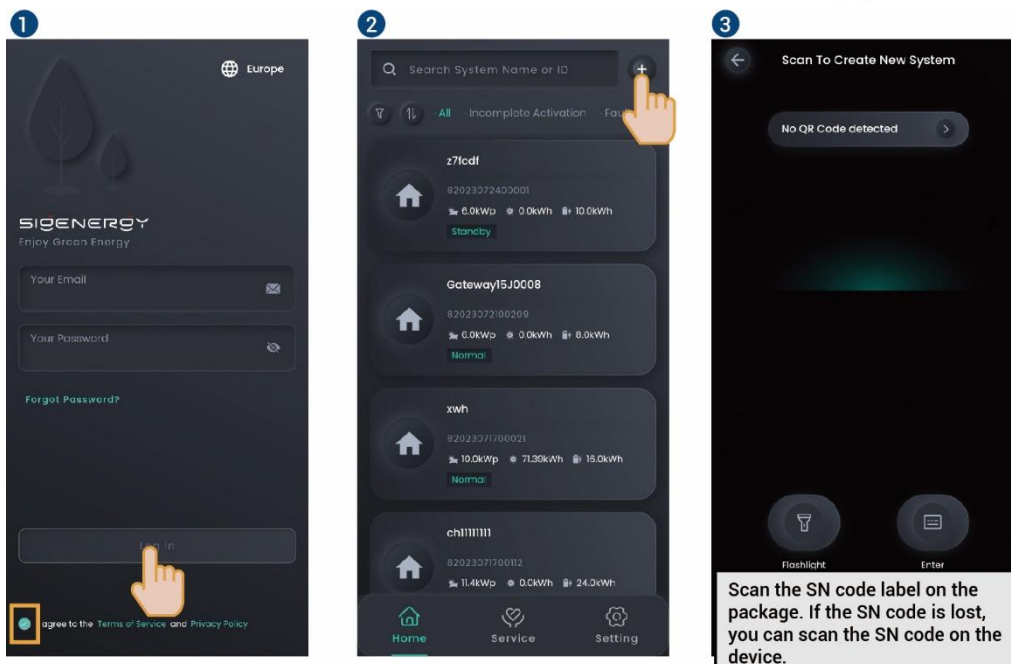

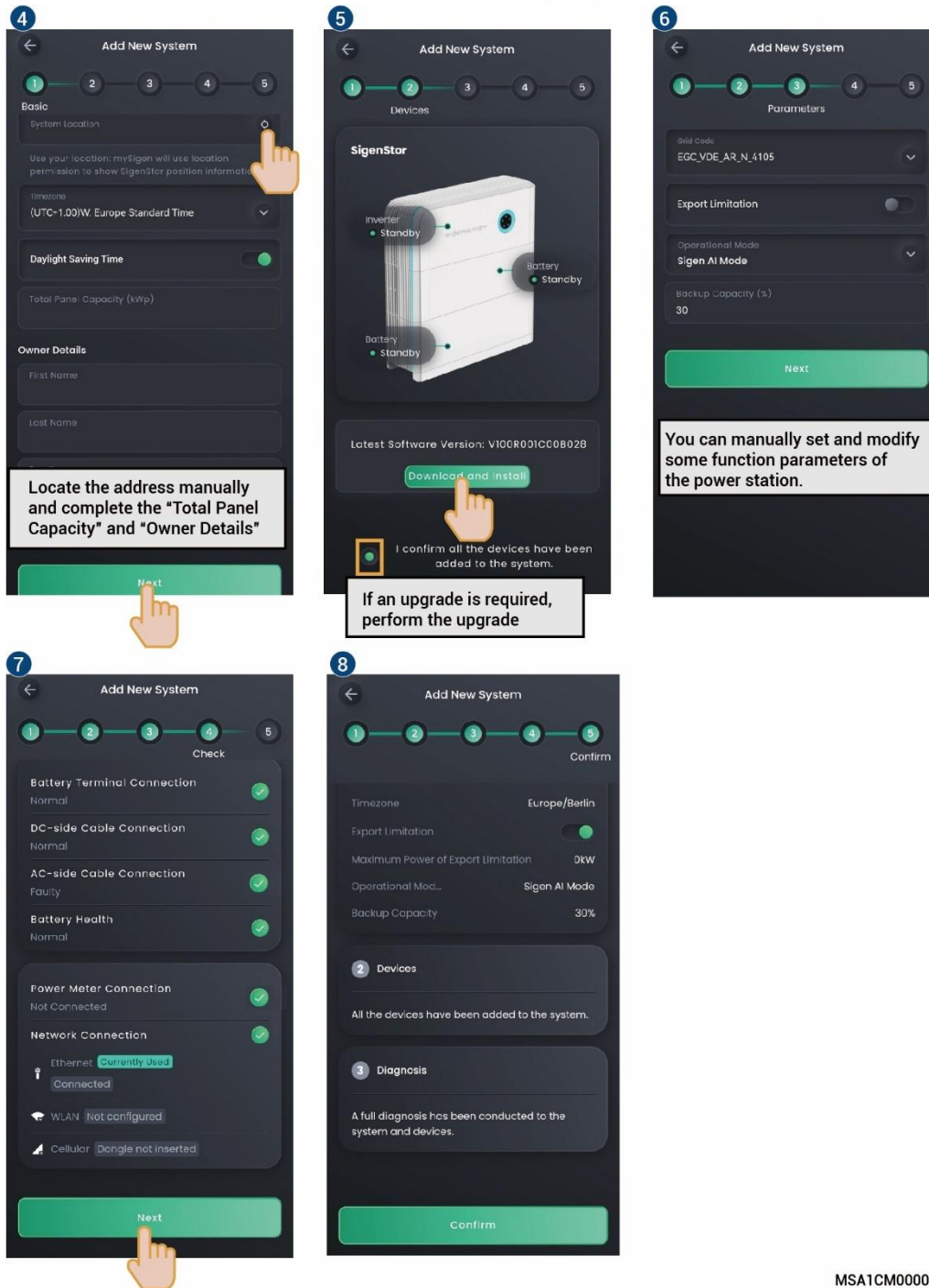

MSA1CM00002

















- Kindly inform the account holder to check the "sigenergy" email within 24 hours and complete the account activation.

Chapter 2 Daily O&M of Power Station & Equipment

Tips

- **It is recommended to use the Sigen Cloud WEB version or MAC/Windows version for routine maintenance.**
 - **This document takes WEB as an example to describe the operation steps. The screenshots in the document are for illustrative purposes only, and there may be differences in the web interface in different periods. Please refer to the actual interface.**
-
- Website of the WEB version: <https://app-eu.sigencloud.com>; for best compatibility and performance, Chromium-based browsers, such as Google Chrome, are recommended.
 - MAC/Windows applications: Please download and install the App at the "Support" → "Download" interface of our official website (<https://www.sigenenergy.com>).

2.1 Connotation of Signs

| Sign | Description | Sign | Description |
|---|---|---|---|
|  | Search icon. Enter keywords in the input box to search for power stations, etc. |  | Increase/decrease button. Click to adjust the time |
|  | Filter button Click to filter by criteria |  | Enlarge button. Click to enlarge the interface |
|  | Back button Click to return to the parent interface |  | Expand icon. Click to view more information or set up more parameters |
|  | More button. Click to view more information or set up more parameters |  | Collapse/expand icon |
|  | OFF/ON button Click to switch settings |  | To-choose box Click To select. Then, different meanings will be filled with different colors, such as To Grid |
|  | Status indicator after inspection: Inspection succeeded |  | Status indicator after inspection: Inspection failed |
|  | Equipment status indicator: "Normal" or "Standby" |  | Equipment status indicator: "Power-off" |
|  | Equipment status indicator: "Offline" |  | Equipment status indicator: "Faulty" |

2.2 View the Operation Information

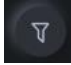
Click “Home” to view the status of all power stations; click  in the upper left corner to filter the power stations in various states.

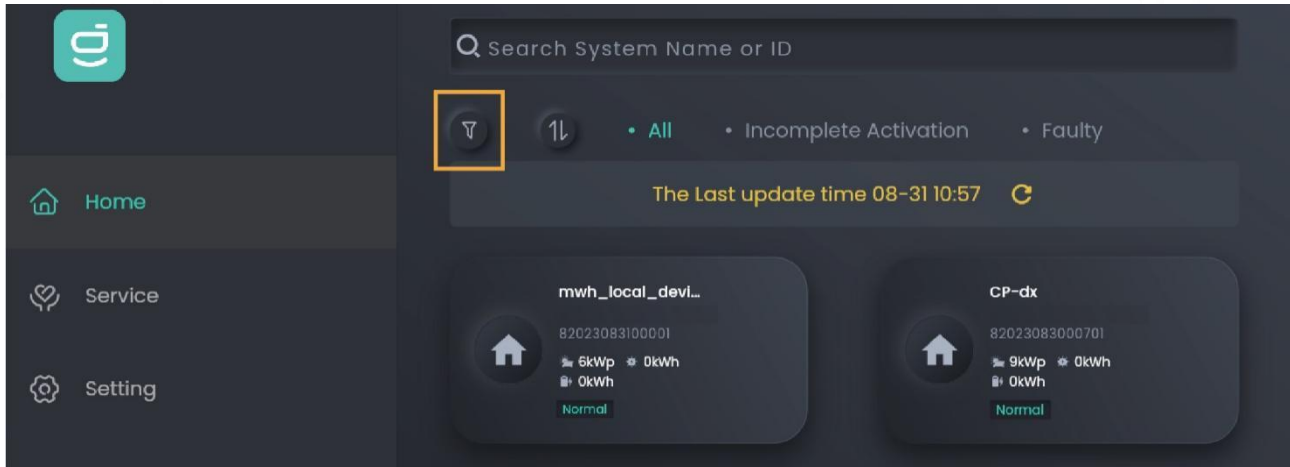

MSA1CM00004

2.2.1 Power station information

Click the name of the power station to inquire about on the “Home” screen to view the detailed energy yield and revenue, etc., of the power station.

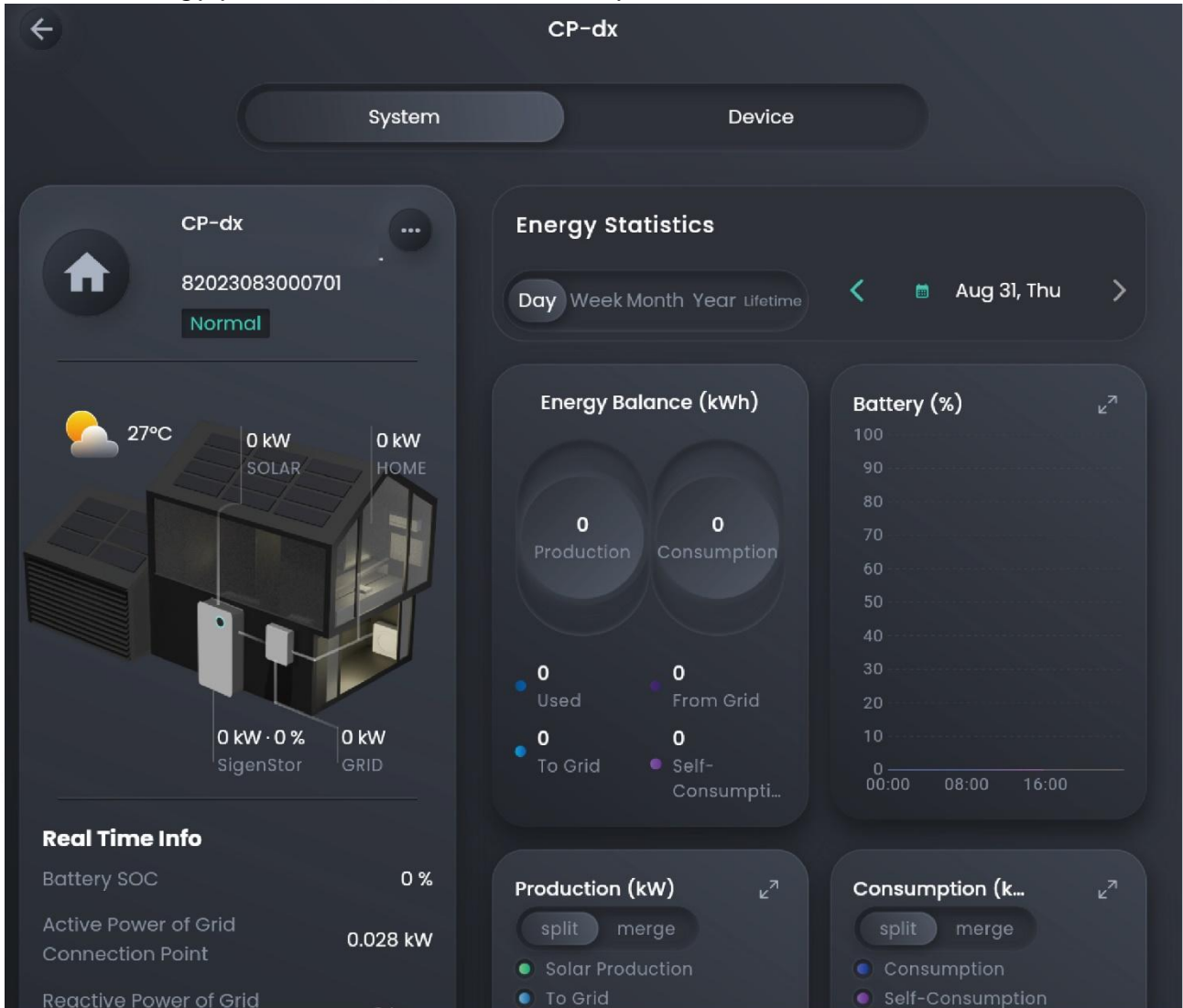

MSA1CM00003

2.2.2 Device information

1. Tap the name of the power station where the device resides on the “Home” screen.
2. Click the device on the energy flow chart in the “System” tab or click the “Device” tab to view the device information.

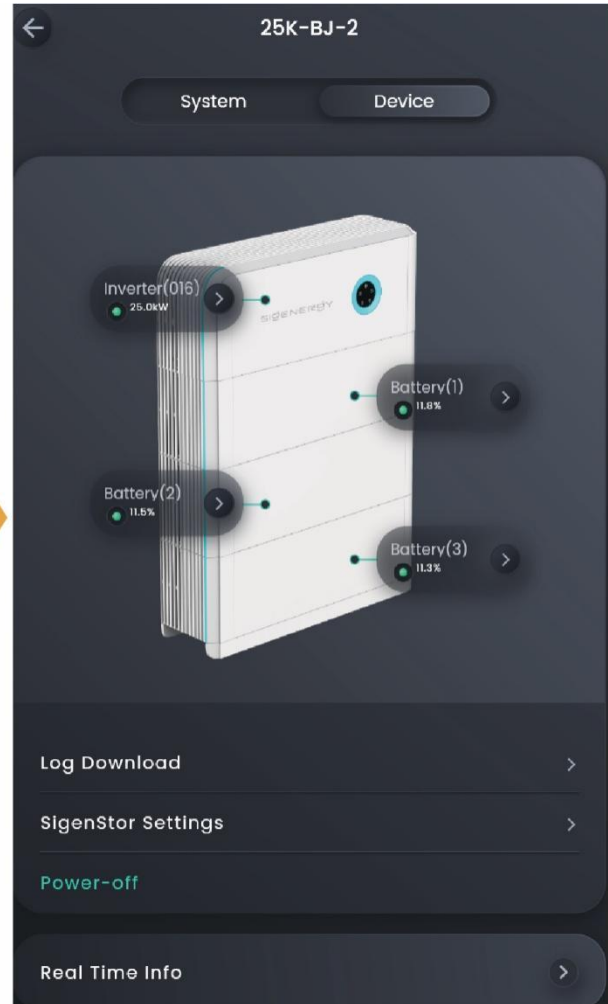
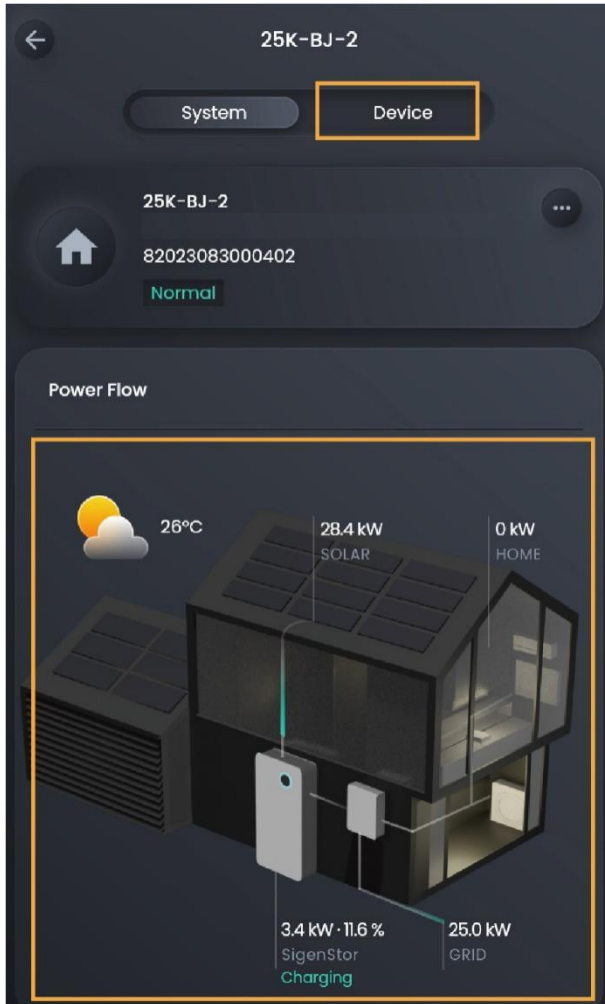

MSA1CM00005

2.3 Query Alarm Information

2.3.1 All power station alarms

In the event of a fault, an alarm will be sent via the mySigen app with the description of how to solve the fault. For the meaning of the alarm code, please refer to Alarm List, which explains what each code means. The alarm would not disappear until it is solved. Click "Service" to view the alarm information of all power stations.

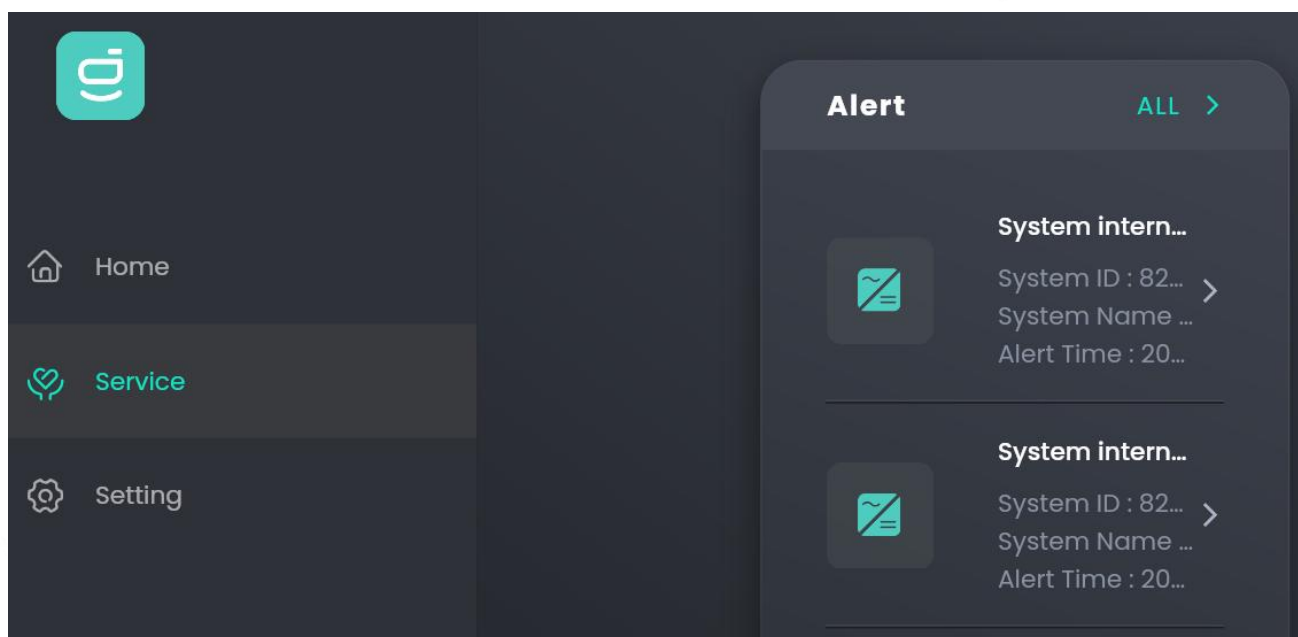

2.3.2 Single power station alarm

1. Tap the name of the power station to query on the “Home” screen.

2. Click  behind the station name, and tap “Notice” to query the alarm of this station.

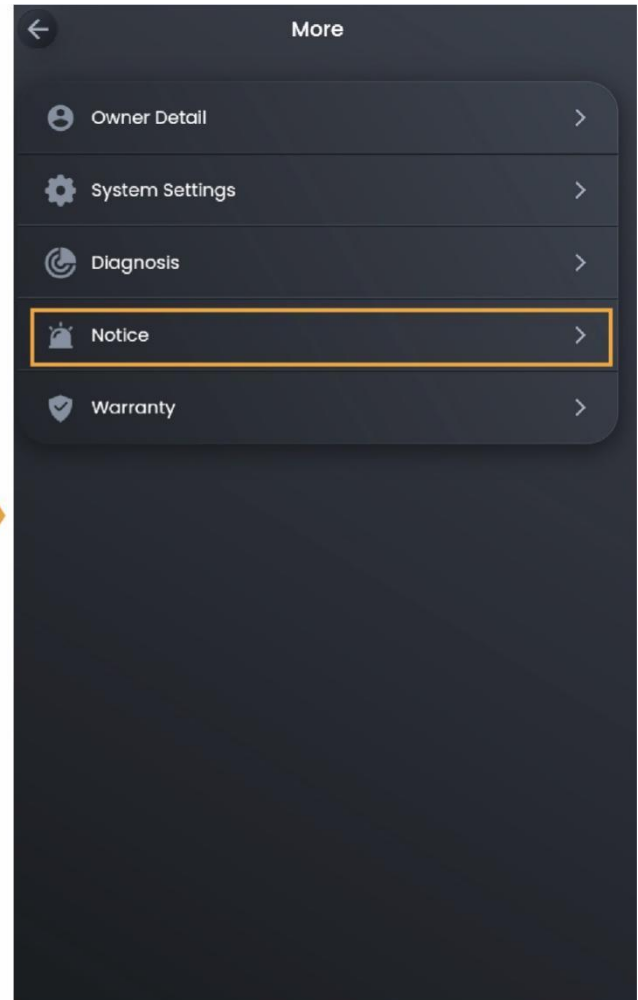
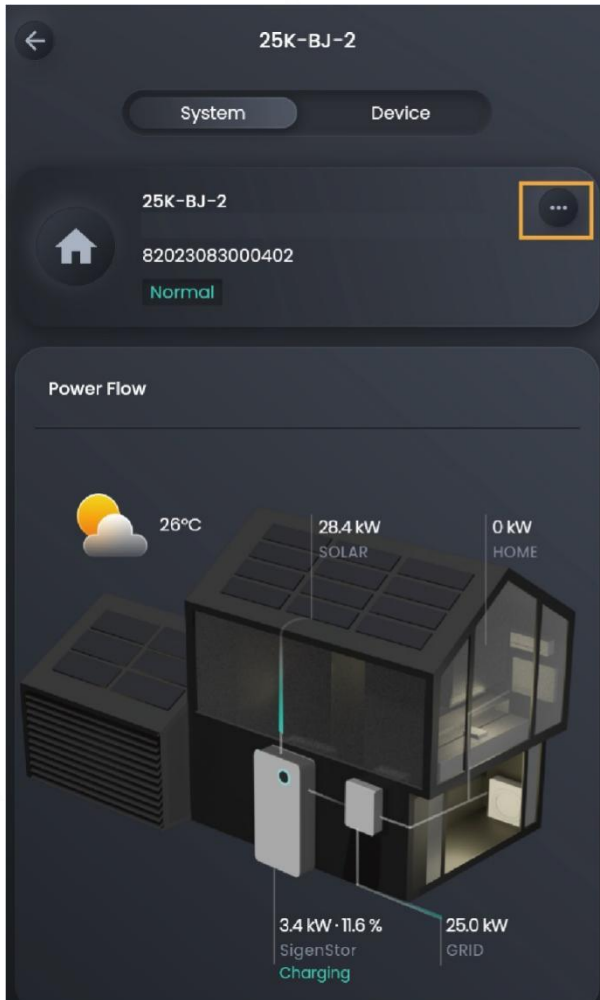

MSA1CM00006

2.4 Power Station Parameter Setup

2.4.1 Change the station name

1. Tap the name of the power station to set up on the “Home” screen.

2. Click  behind the station name, and tap “System Settings” → “System Name” to change the name.

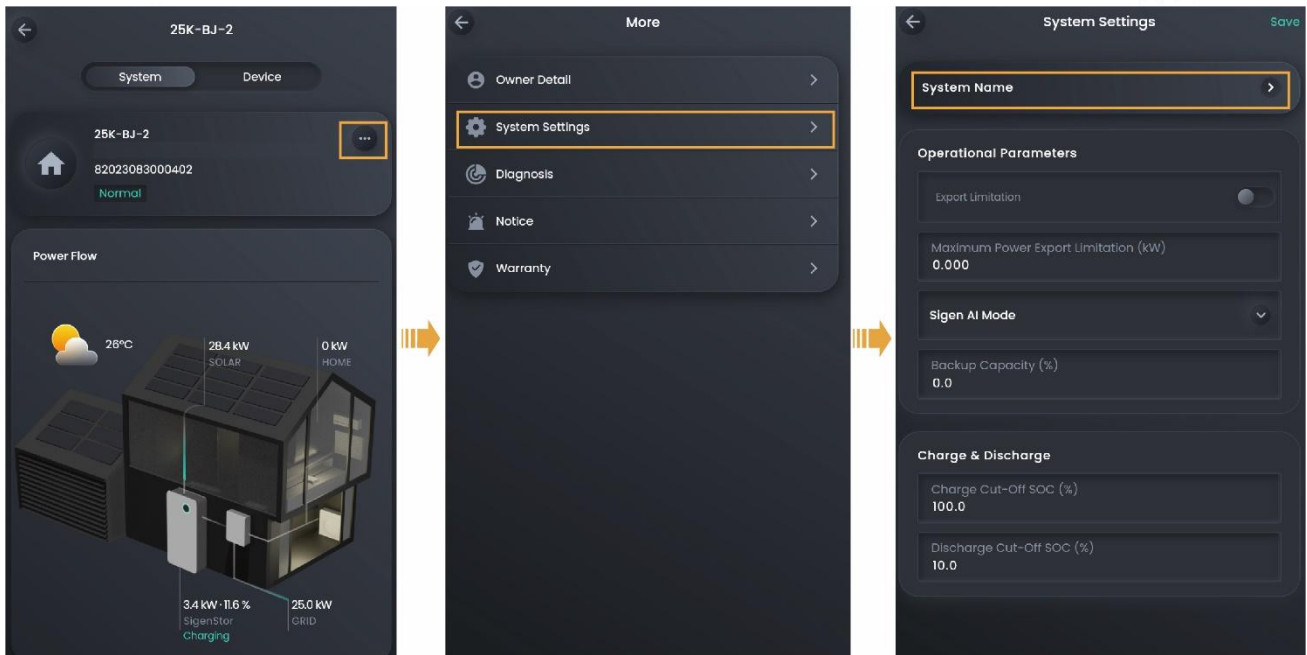

MSA1CM00006

2.4.2 Set the energy storage operating mode

Tips

The energy storage system has three operating modes, namely, “Sigen AI Mode”, “Self-consumption mode”, “Fully Fed to Grid”. The “Sigen AI Mode” is recommended.

1. Tap the name of the power station to set up on the “Home” screen.

2. Click  behind the station name, and tap “System Settings” to change the operating mode.

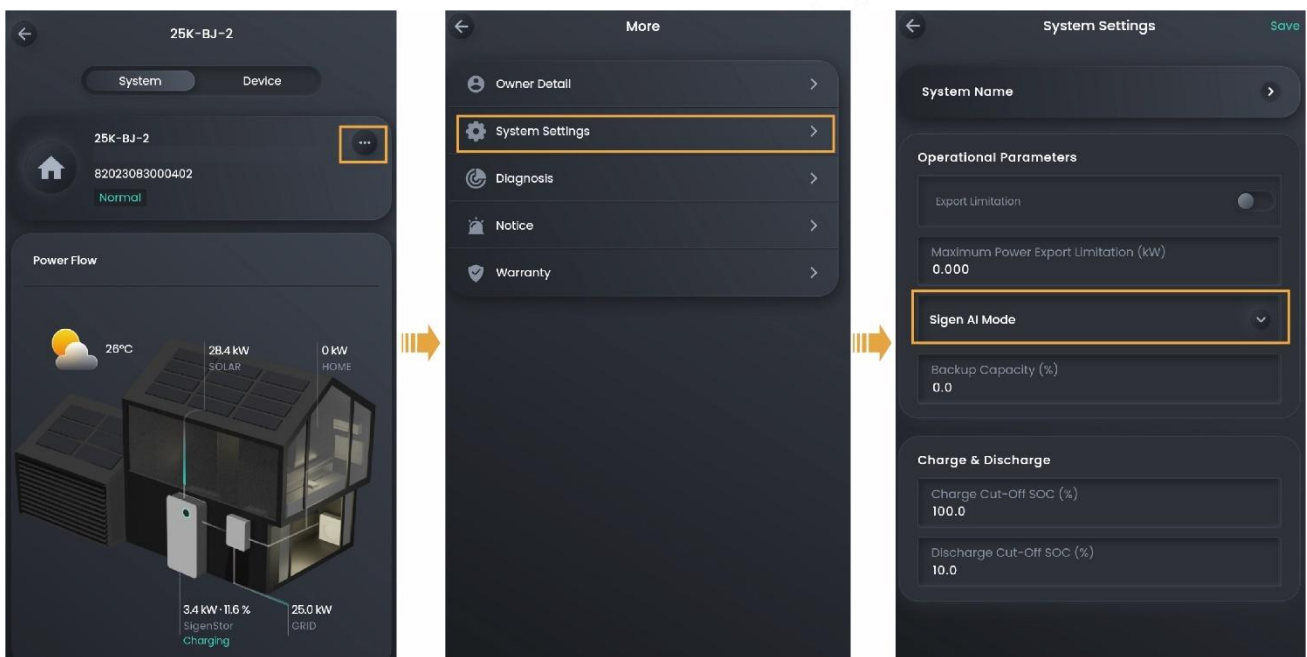

MSA1CM00006

Sigen AI Mode

By recording the peaks and troughs of users' consumption habits and local electricity prices for one week, Sigen AI mode can customize smart electricity solutions to maximize savings for customers.

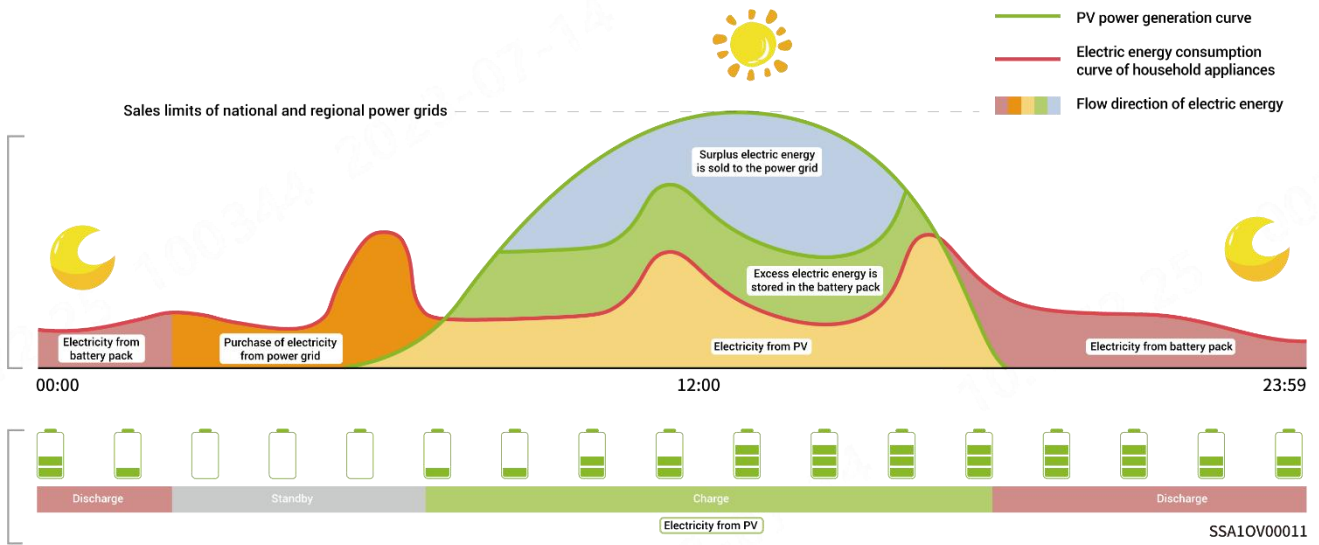

Self-consumption mode

The excess photovoltaic power output is stored in the battery. When the photovoltaic power generation is insufficient or there is no photovoltaic power generation at night, electric energy is released from the battery for load operation, so as to improve the percentage of electricity generated for in-house use and the self-sufficiency rate of household energy, thus saving electricity costs.

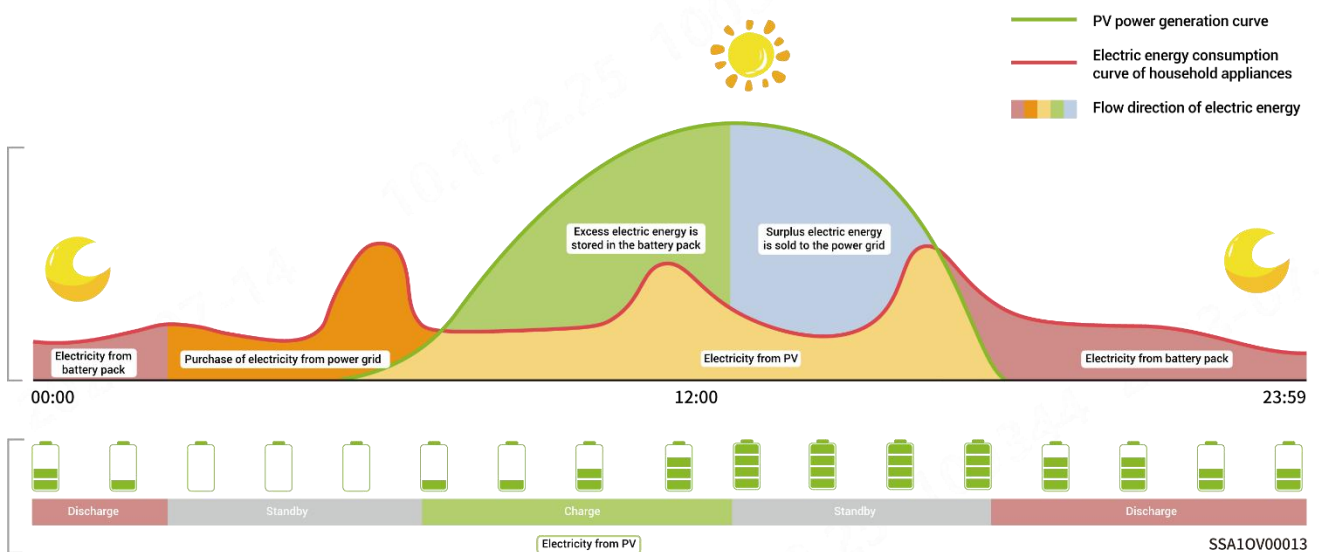

Fully Fed to Grid

The PV power generation can be maximized for sale to the power grid. During the daytime when the PV-generated power is greater than maximum output capacity of the inverter, the inverter stays at maximum output while the excess electricity is stored in batteries; when the PV-generated power is lower than maximum output capacity of the inverter or when no PV power is generated at night, the batteries are discharged to ensure that the inverter can maximize the output.

Backup Reserve

If there is a Gateway in the network, you can manually set the “Backup Reserve” value in mySigen App. When the grid is connected, the battery stops discharging when the set backup SOC is reached; when the grid is powered down, the battery power from the backup can be used.

Example: Self-Consumption Mode involves backup SOC.

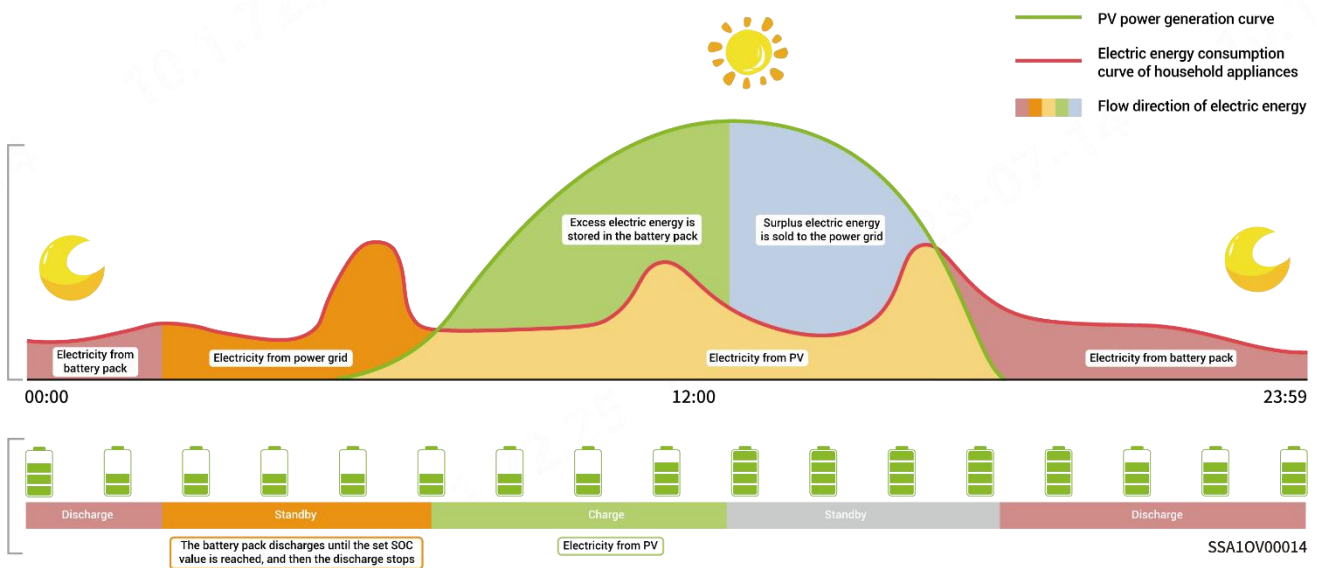

2.4.3 Charge & discharge settings

1. Tap the name of the power station to set up on the “Home” screen.
2. Click  behind the station name, and tap “System Settings” → “Charge & Discharge” to set up the charge & discharge.

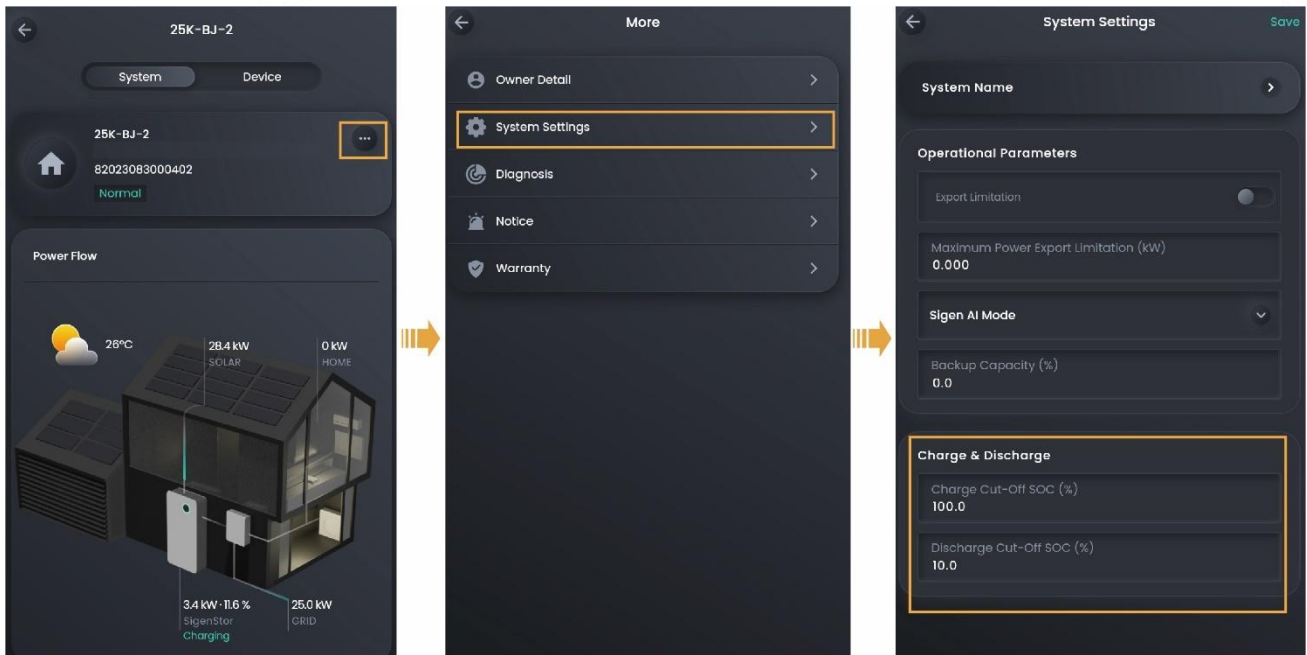

MSA1CM00006

| SN. | Parameter name | Description |
|-----|-----------------------|---|
| 1 | Charge Cut-off SOC | Set the capacity at which the battery pack stops charging. |
| 2 | Discharge Cut-off SOC | Set the capacity at which the battery pack stops discharging. <ul style="list-style-type: none"> ● The permissible range is 0%-20%, but you are advised not to set this parameter to 0 to avoid irreversible attenuation caused by the battery pack not being charged in time. ● In backup networking, “Backup Capacity” is preferred; in non-backup networking, this parameter is preferred. |

2.4.4 Reserve capacity setup

Tips

- **When there is a Gateway in the networking, the backup capacity parameter can be set up.**
- **In grid-connected scenarios, the battery pack will no longer be discharged when it is discharged to the backup capacity level. In off-grid scenarios, the battery pack supplies power to the electrical equipment and stops discharging when it reaches the set "Discharge Cut-off SOC".**
- **Users set this manually depending on the region's power failure frequency and the time away from home. You are advised not to set this parameter to 0 to avoid irreversible attenuation caused by the battery pack not being charged in time.**

1. Tap the name of the power station to set up on the "Home" screen.

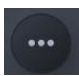
2. Click  behind the station name, and tap "System Settings" → "Backup Capacity" to set the backup capacity.

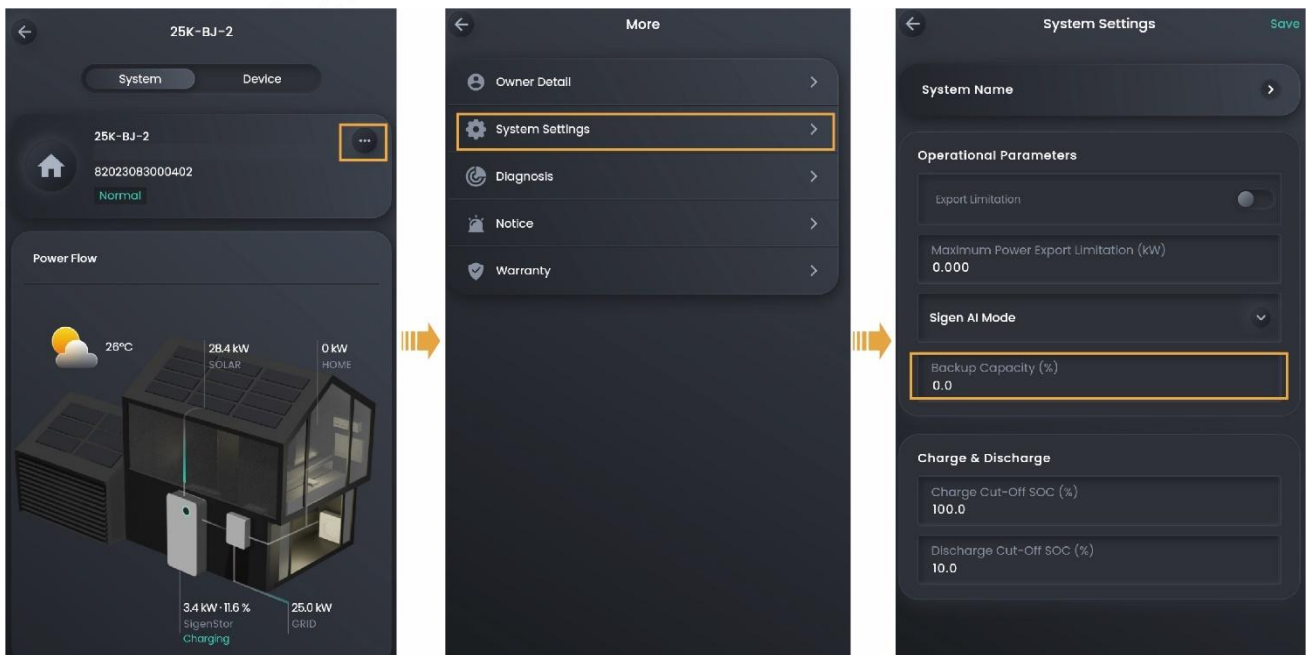

MSA1CM00006

2.4.5 Power Station Detection

1. Tap the name of the power station to set up on the “Home” screen.
2. Click  behind the station name, and tap “System Settings” → “Backup Capacity” to detect.

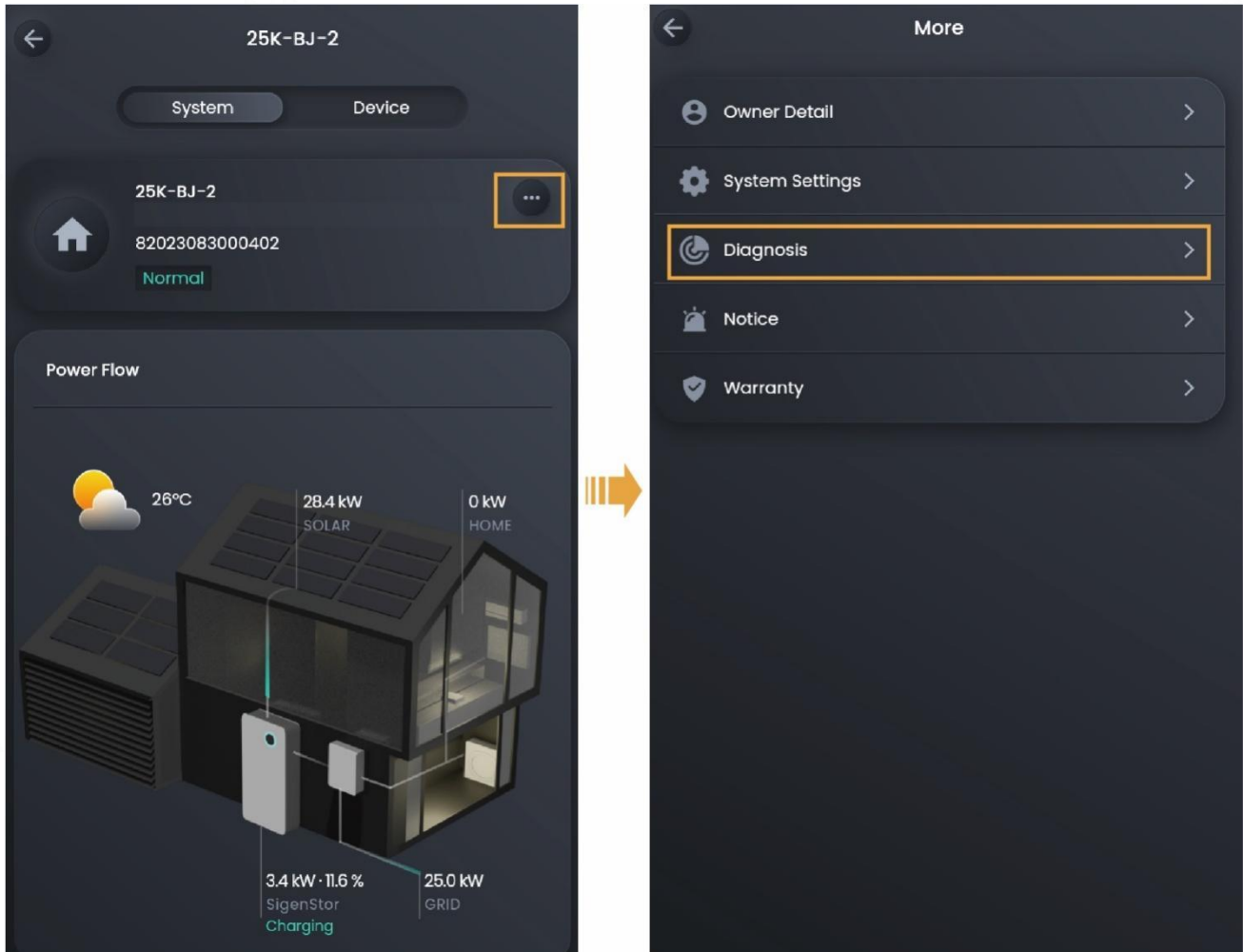

MSA1CM00006

2.5 Device Parameters Setup

2.5.1 Log download

Tips

When a device malfunctions and you need to locate the problem, you can download device logs for analysis.

1. Tap the name of the power station where the device resides on the “Home” screen.
2. Click the device on the energy flow chart in the “System” tab or click the “Device” tab.
3. Click “Log Download” to download.

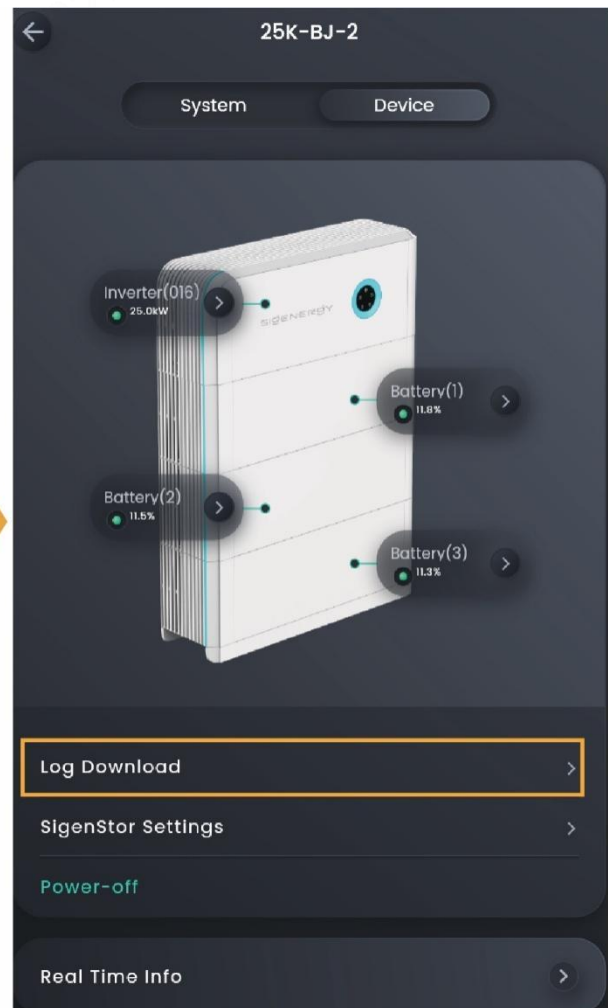
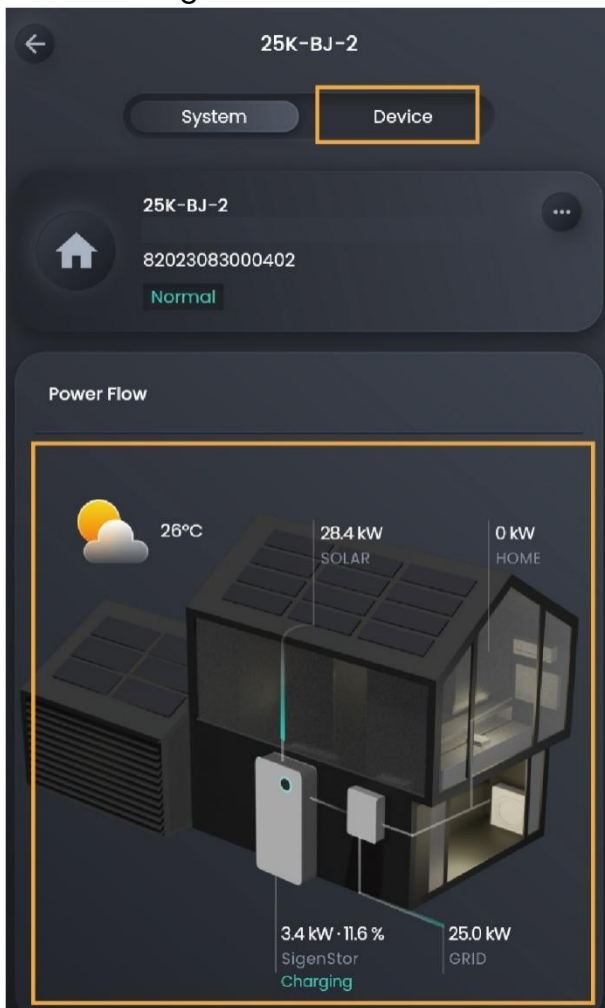

MSA1CM00005

2.5.2 Inverter parameters setup

1. Tap the name of the power station where the device resides on the “Home” screen.
2. Click the device on the energy flow chart in the “System” tab or click the “Device” tab.
3. Click “Inverter” to enter the inverter interface. And the firmware version of the devices can be found as below

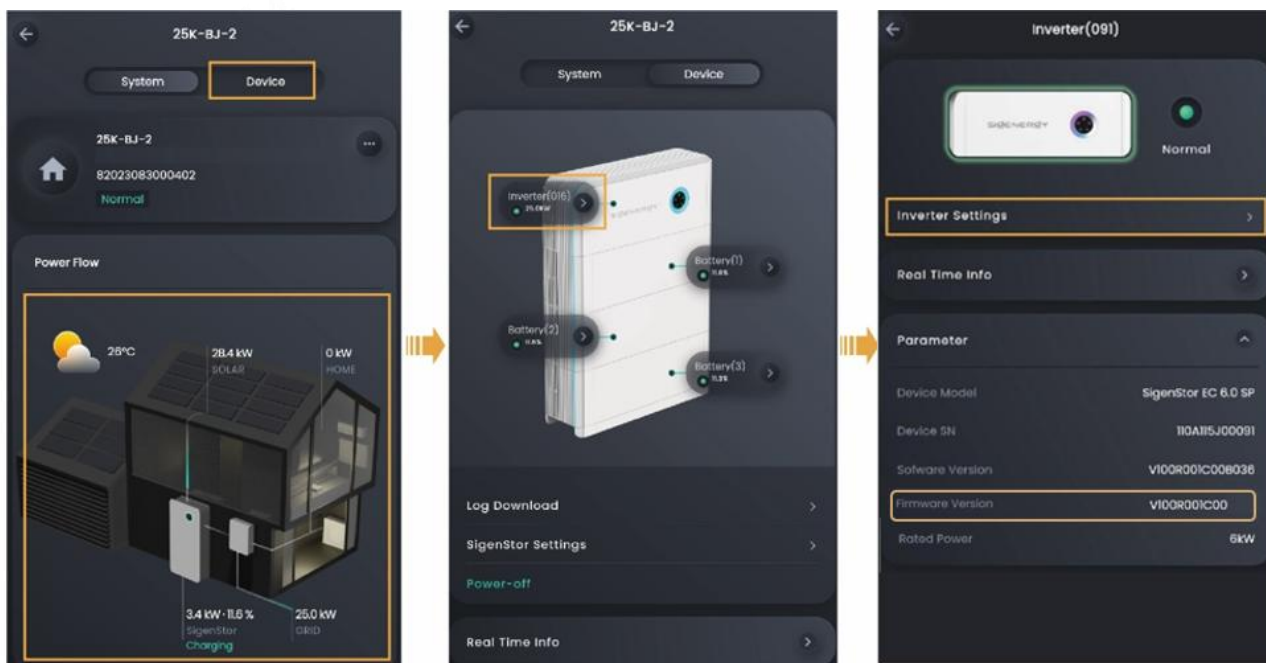

Power

| SN. | Parameter name | Description |
|-----|--|--|
| 1 | Fixed value adjustment of active power | Adjust the active power output of the device based on the set fixed value. |
| 2 | Percentage active power adjustment | Adjust the active power output of the device based on the set percentage. |
| 3 | Fixed value adjustment of reactive power | Adjust the reactive power output of the device based on the set fixed value. |
| 4 | Reactive power Q/S regulation | Adjust the reactive power output of the device based on the ratio of the set reactive power to the apparent power of the device. |
| 5 | Power factor adjustment | Adjust the reactive power output of the device based on the set power factor. |
| 6 | Active power gradient | Set the speed of active power scheduling. |
| 7 | Reactive power variation gradient | Set the speed of reactive power scheduling. |
| 9 | Insulation impedance threshold | To protect device security, the device cannot run when it detects that the actual insulation impedance output by the PV array to the ground is lower than the value set in this parameter. |

Frequency Setting

| SN. | Parameter name | Description |
|-----|-------------------------------|--|
| 1 | Overfrequency Derating Enable | When  , the output power of the device will be limited if the grid frequency is greater than the trigger value. |

Voltage Protection

| SN. | Parameter name | Description |
|-----|---|---|
| 1 | Level- N Overvoltage Protection Threshold | Set the level- N overvoltage protection value of the grid voltage. When the actual voltage is greater than the set protection value and the set protection time is elapsed, the device alarm will be triggered; otherwise, the alarm will be cleared. |
| 2 | Level- N Overvoltage Protection Duration | Set the level- N overvoltage protection time for grid voltage. |
| 3 | Level- N Undervoltage Protection Threshold | Set the level- N undervoltage protection value of the grid voltage. When the actual voltage is smaller than the set protection value and the set protection time is elapsed, the device alarm will be triggered; otherwise, the alarm will be cleared. |
| 4 | Level- N Undervoltage Protection Duration | Set the level- N undervoltage protection time for grid voltage. |

Note: **N** represents 1-3. The settable parameters of "Voltage Protection" are associated with "Grid Code"; the parameters that can be set are based on the actual screen.

Frequency Protection

| SN. | Parameter name | Description |
|-----|---|---|
| 1 | Level- N Overfrequency Protection Threshold | Set the level- N overfrequency protection value of the grid voltage. When the actual voltage is greater than the set protection value and the set protection time is elapsed, the device alarm will be triggered; otherwise, the alarm will be cleared. |
| 2 | Level- N Overfrequency Protection Duration | Set the level- N overfrequency protection time for grid voltage. |
| 3 | Level- N Underfrequency Protection Threshold | Set the level- N underfrequency protection value of the grid voltage. When the actual voltage is smaller than the set protection value and the set protection time is elapsed, the device alarm will be triggered; otherwise, the alarm will be cleared. |
| 4 | Level- N Underfrequency Protection Duration | Set the level- N underfrequency protection time for grid voltage. |

Note: **N** represents 1-3. The settable parameters of "Frequency Protection" are associated with "Grid Code"; the parameters that can be set are based on the actual screen.

2.5.3 SigenStor settings

1. Tap the name of the power station where the device resides on the “Home” screen.
2. Click the device on the energy flow chart in the “System” tab or click the “Device” tab.
3. Click “SigenStor Settings” to enter the setting interface.

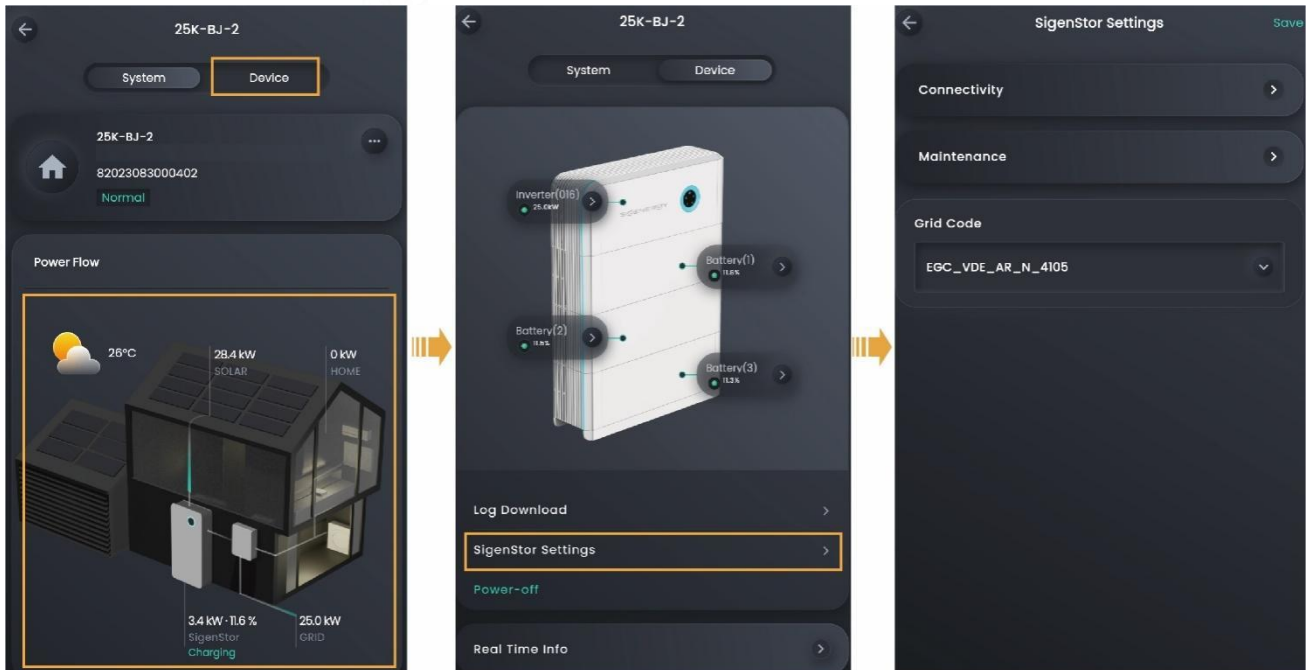

MSA1CM00005

Change the type of network connection

Click “Connectivity” to change the network connection type as required.

Tips

- Before activating the WLAN communication, ensure that an antenna is installed on the device.
- Please make sure that Sigen CommMod is installed on the device before activating the 4G communication.
- It is recommended to use FE and WLAN for communication. Sigen CommMod users must top up their own 4G data plan after a period of 2 years.

Historical Information Maintenance

Click “Maintenance” to clear the historical data.

Tips

- Run Reset to restart the device.
- Run the “Erase All Content” command to clear the 5-minute performance data, alarms, and hour-day-month-year energy yield. Exercise caution when performing this operation.

Change the power grid standard code

Click "Grid Code" and set it to local requirements.

Setting Reactive Power Control (for Australia)

1. Setup Fixed Power Factor Mode and Fixed Reactive Power Mode

Fixed Power Factor Mode

Step 1 : Select reactive power settings.

Step 2 : Select PF and enter the power factor according to your local grid regulation. The power factor range is from 0.8 leading ~ 0.8 lagging.

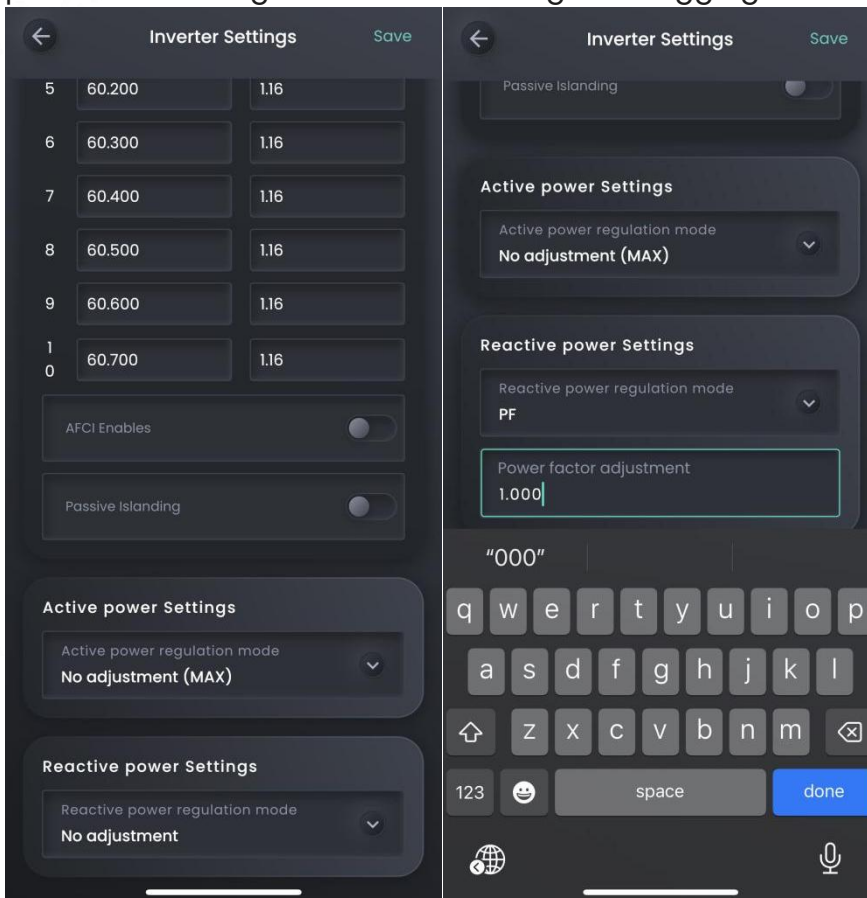

Fixed Reactive Power Mode

Step 1 : Select reactive power settings.

Step 2 : Select Fixed value adjustment and enter the fixed value adjustment of reactive power according to your local grid regulation. The power range is from $-60\%P_n$ ~ $60\%P_n$.

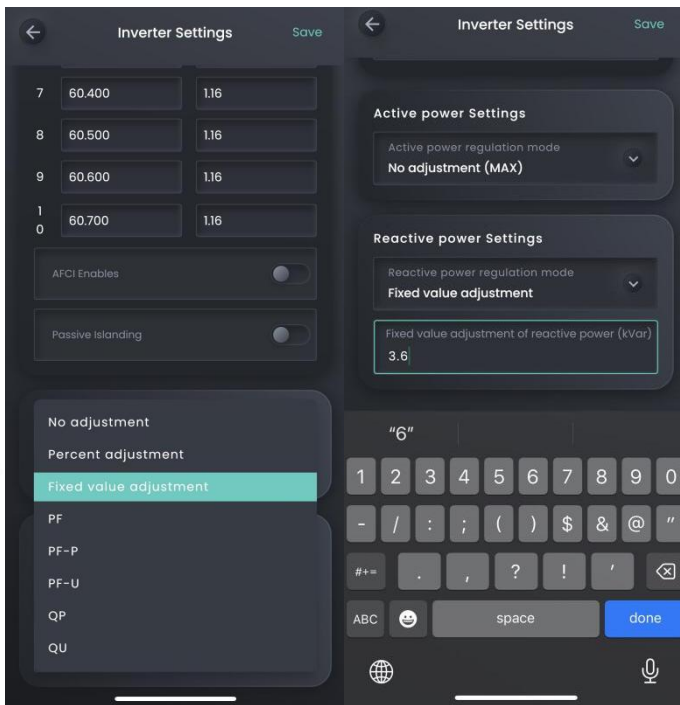

2. Setup V-Watt and Volt-Var Mode

This inverter complies with AS/NZS 4777.2: 2020 for power quality response modes. The inverter satisfies different regions of DNSPs' grid connection rules requirements for volt-watt and volt-var Settings. e.g.: AS4777 series setting as below Figures.

| Region | Default value | V _{w1} | V _{w2} |
|---------------|--|-----------------|-----------------|
| Australia A | Voltage | 253 V | 260 V |
| | Inverter maximum active power output level (P) % of S _{rated} | 100 % | 20 % |
| Australia B | Voltage | 250 V | 260 V |
| | Inverter maximum active power output level (P) % of S _{rated} | 100 % | 20 % |
| Australia C | Voltage | 253 V | 260 V |
| | Inverter maximum active power output level (P) % of S _{rated} | 100 % | 20 % |
| New Zealand | Voltage | 242 V | 250 V |
| | Inverter maximum active power output level (P) % of S _{rated} | 100 % | 20 % |
| Allowed range | Voltage | 235 to 255 V | 240 to 265 V |
| | Inverter maximum active power output level (P) % of S _{rated} | 100 % | 0 % to 20 % |

NOTE Australia C parameter set is intended for application in isolated or remote power systems.

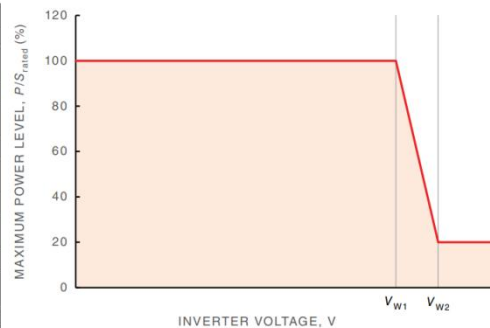

| Region | Default value | V _{v1} | V _{v2} | V _{v3} | V _{v4} |
|---------------|---|----------------------|-----------------|-----------------|----------------------|
| Australia A | Voltage | 207 V | 220 V | 240 V | 258 V |
| | Inverter reactive power level (Q) % of S _{rated} | 44 % supplying | 0 % | 0 % | 60 % absorbing |
| Australia B | Voltage | 205 V | 220 V | 235 V | 255 V |
| | Inverter reactive power level (Q) % of S _{rated} | 30 % supplying | 0 % | 0 % | 40 % absorbing |
| Australia C | Voltage | 215 V | 230 V | 240 V | 255 V |
| | Inverter reactive power level (Q) % of S _{rated} | 44 % supplying | 0 % | 0 % | 60 % absorbing |
| New Zealand | Voltage | 207 V | 220 V | 235 V | 244 V |
| | Inverter reactive power level (Q) % of S _{rated} | 60 % supplying | 0 % | 0 % | 60 % absorbing |
| Allowed Range | Voltage | 180 to 230 V | 180 to 230 V | 230 to 265 V | 230 to 265 V |
| | Inverter reactive power level (Q) % of S _{rated} | 30 to 60 % supplying | 0 % | 0 % | 30 to 60 % absorbing |

NOTE 1 Inverters may operate at a reactive power level with a range up to 100 % supplying or absorbing.
NOTE 2 Australia C parameter set is intended for application in isolated or remote power systems.

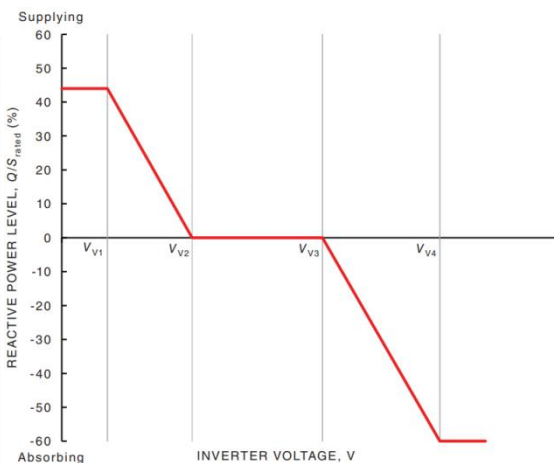

Setting procedure:

1. AS4777 grid compliance has been set during production, please select corresponding grid compliance according to state regulation during installation. You can choose a state regulation compliance with your local grid via mySigen App.

2. Select reactive power settings and choose QU mode and enable P-U voltage derating settings to enter DNSPs settings.

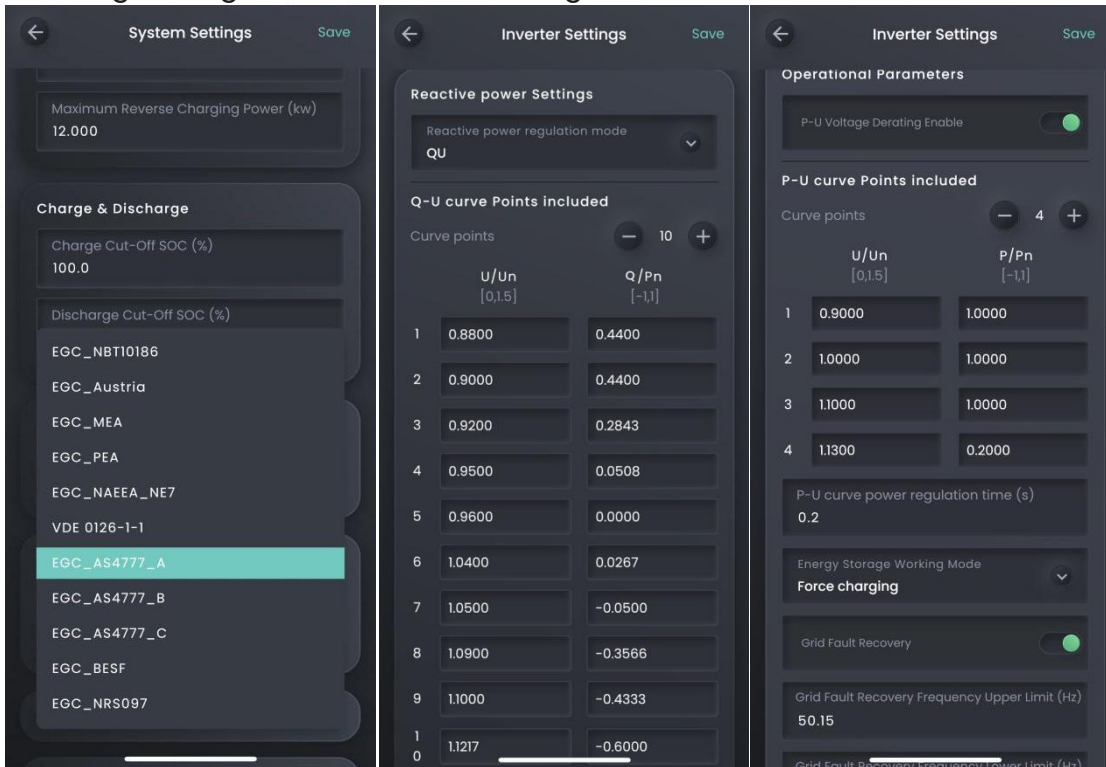

Note: With regard to the Power rate limit mode, Sigenergy sets the product WGrA to 16.67%Pn by default in the following cases according to the requirements of 3.3.4.2 as 4777.2: 2020.

1. Soft ramp up after connect,
2. Reconnect or soft ramp up/down following a response to frequency disturbance.

2.5.4 Equipment Powering-on/Power-off

1. Tap the name of the power station where the device resides on the “Home” screen.
2. Click the device on the energy flow chart in the “System” tab or click the “Device” tab.
3. Click “Power-off” or “Power-on” to switch the device on or off.

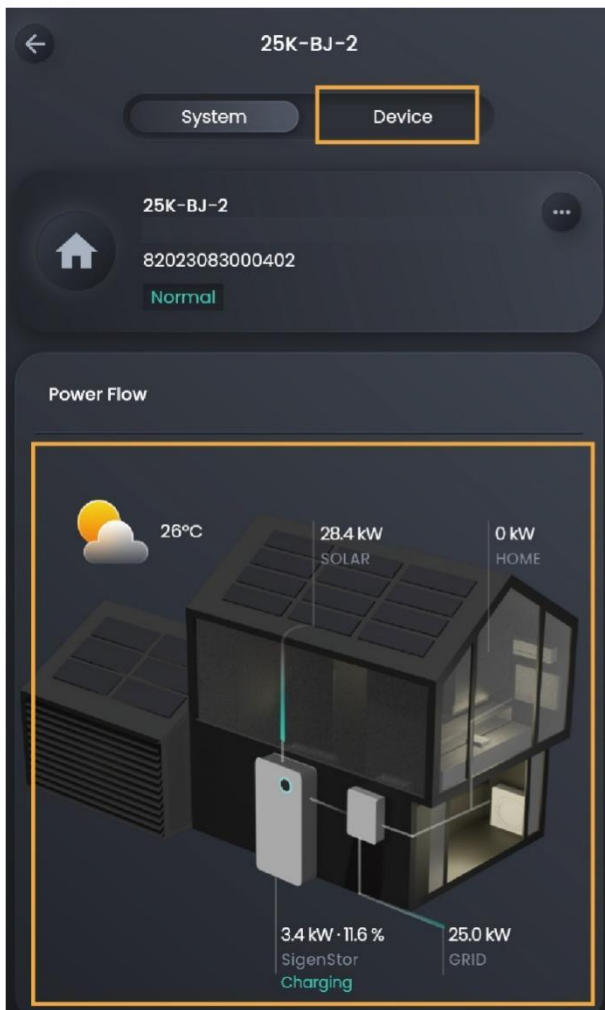

MSA1CM00005

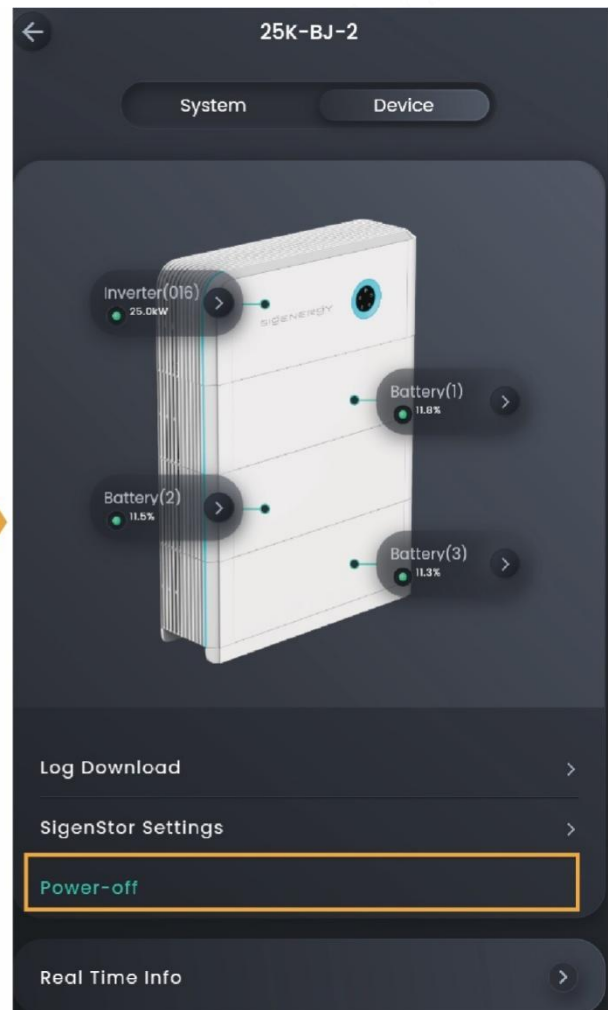

Chapter 3 Others

3.1.1 Change password

Tap "Forgot Password" on the login screen to reset the password.

3.1.2 Change language

Click "Setting" → "App Setting" → "Language" → "Select Language" to change the language.

3.1.3 Change nickname

Click "Setting" and click  at the top of the screen to change the "Nickname".

3.1.4 Change the Interface Style

Click "Setting" → "App Setting" → "Dark Mode" → "Select Style" to change the style.

3.1.5 Upgrade the mySigen software

Tips

For best compatibility and performance, mySigen App, Sigen Cloud's MAC, and Windows app versions are recommended to be upgraded regularly. Skip this section for the web version.

Click "Setting" → "About" → "Version Update" to upgrade the App.

3.1.6 View warranty information

1. Tap the name of the power station to view on the "Home" screen.
2. Click  behind the station name, and tap "Warranty".

Chapter 4 Exit the Account

Click "Setting", click  at the top of the screen, and tap "Log out".

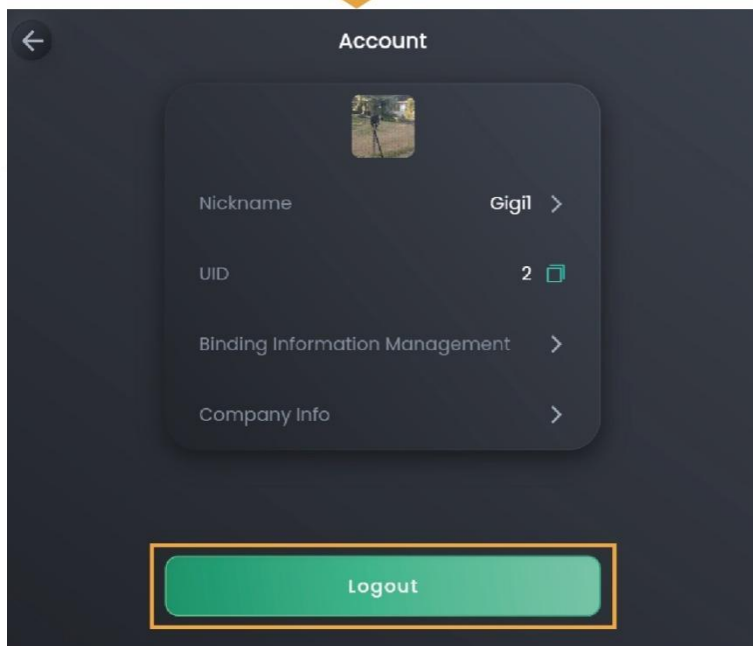
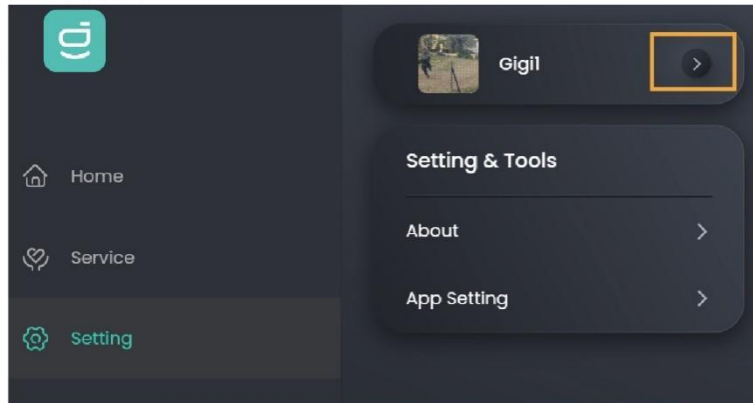

MSA1CM00007

Chapter 5 FAQs

5.1 What if the user does not receive the account activation email?

- You can check the “Junk Mail” in your email box to see if you have received any emails regarding the “sigencloud” account.
- If nothing is found in “Junk Mail”, please confirm that the email information of the user is filled in correctly. If it is incorrect, please reset and push again.

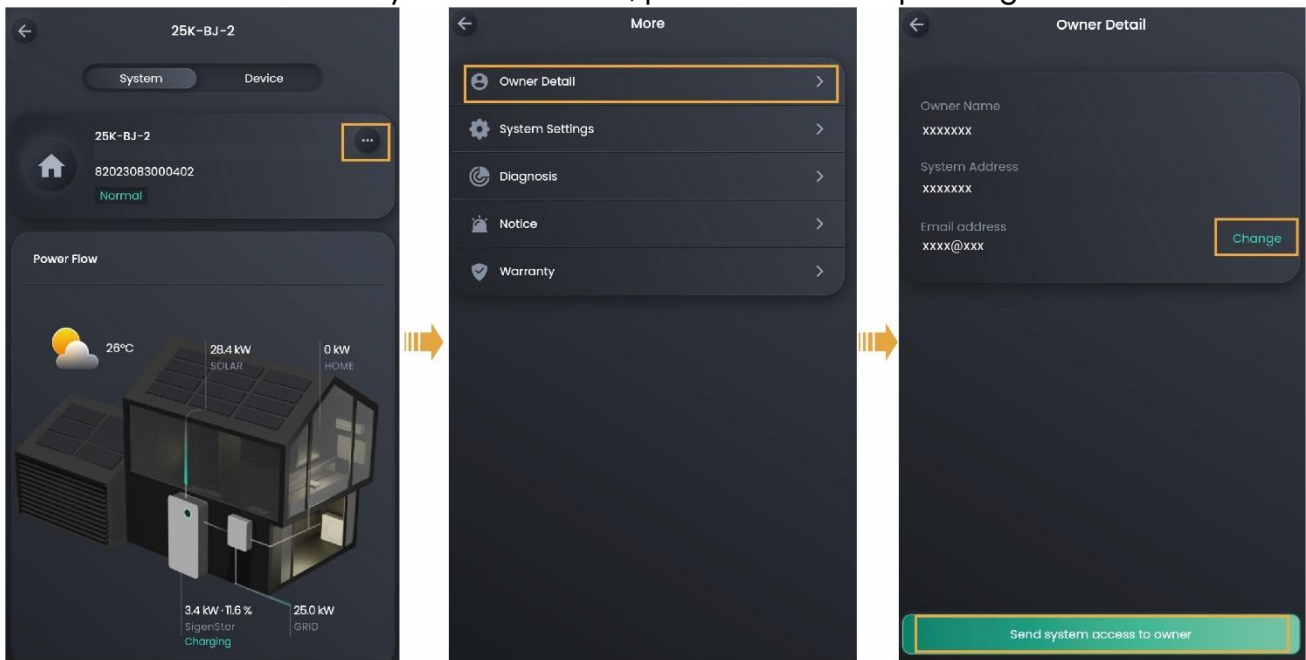

MSA1CM00006

5.2 What should I do if the activation of the account times out?

Please push the account activation information again and notify the user to activate the account within 24h.

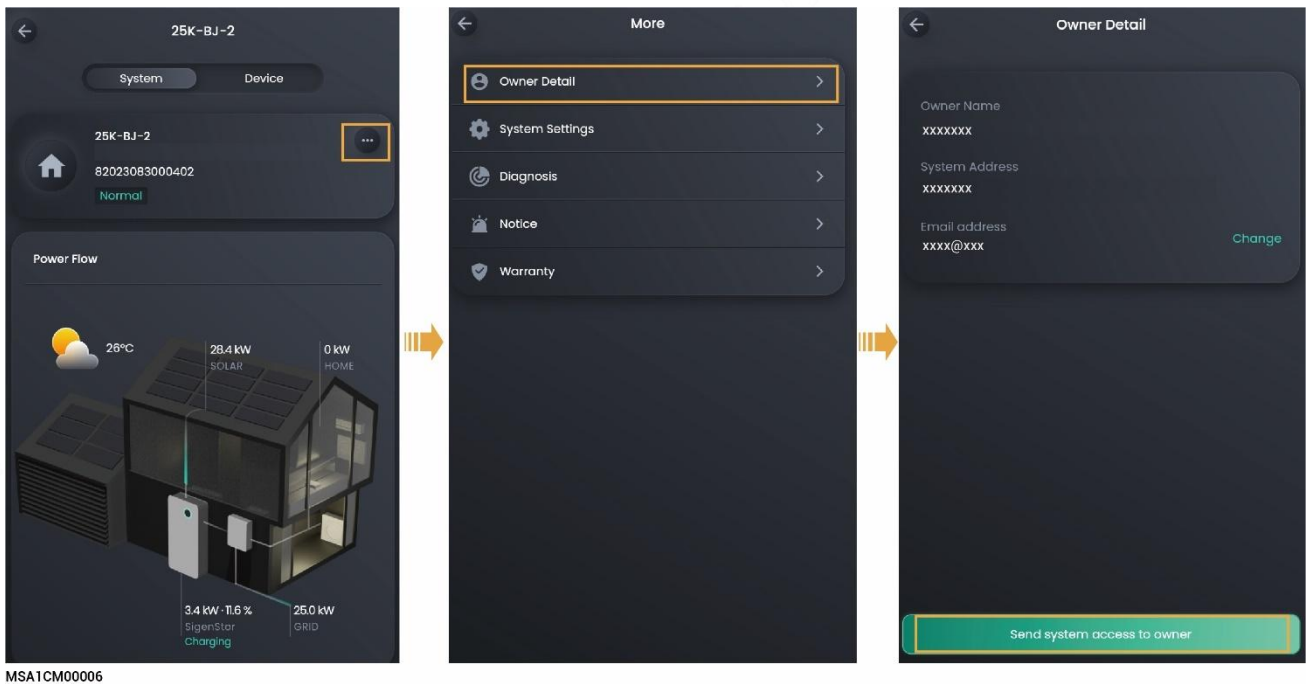

5.3 What should I do if I encounter problems during operations like initiation?

Please get the contact information at “Support” → “Local Contacts” on our official website (<https://www.sigenergy.com>).

5.4 How can I proceed if I haven't received the email (verification code, log, etc.) sent by the system?

- You can check the “Junk Mail” in your email box to see if you have received any emails regarding the “sigencloud” account.
- Send again.